

Mono Basin Mixer

Installation & Aftercare

Specification

Operating Specification

Hot water supply - Max 65°C
Recommended 60-65°C

Operating Pressures

Min 0.5 bar - Max 7.0 bar

Fitting Installation

1. Screw Fixing Studs(7) to the Tap Body(2).
2. Fit Flange(3) with Anti_Rotational Washer(4) to the Tap Body(2), ensure that the Anti_Rotational Washer(4) is fitted to the Flange(3).
3. Screw 2x Braided Connectors(11) to Tap Body(2) through the hole of the Flange(3) by hand.
4. Locate the tap assembly down through the hole of the basin.
5. Fit Rubber Washer(5) and Metal Washer(6) onto the threaded of the Fixing Studs(7), then fit Fixing Nuts(8) onto Fixing Studs(7).
- DO NOT OVER TIGHTEN.**
6. Connect Braided Connectors(11) to the hot and cold water supplies using suitable plumbing joints.
7. Remove the Plug Assembly(14) from Waste Body(15) then unscrew the Waste Body(15) from the Waste Base(18).
8. Insert the Waste Body (15) with Flange Washer (16) to the waste hole in basin.
9. Fit the Waste Base (18) with the Rubber Seal (17) below the basin.
10. Remove the Rod Nut (20) from the Waste Base (18), and then insert the Rod Nut (20) to the Horizontal Rod (10) according to the diagram. And tighten the Rod Nut (20) to Waste Base (18), make sure the Ball Washer (19) is inside the Waste Base (18).
11. Insert Pop up rod (1) into the back hole at the tap body, and then connect the Vertical Rod (13) and Pop up rod (1) by screwing the nut. Connect the vertical rod (13) and Horizontal Rod (10) by tightening the screw of the Rod Connector(9) which at the end of horizontal rod.
12. Turn on the mains water supply and re-fill the system. Check immediately for leaks. It is always advisable at this stage to flush out the system. To do this, open the valve fully and allow water to flow for approximately 1 minute. This will remove any foreign matter within the tap body.
13. Finally turn on all water heating arrangements.

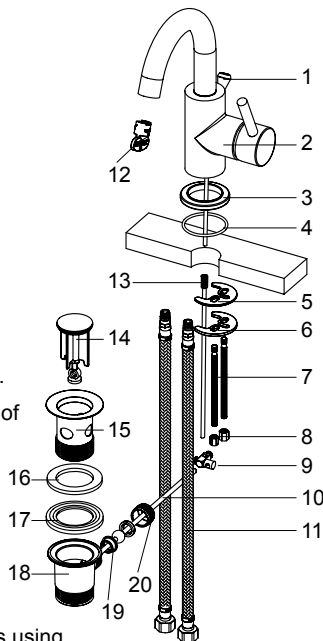

Mono Basin Mixer

Installation & Aftercare

Aftercare

To maintain the appearance of this fitting, ensure it is cleaned using only a clean soft damp cloth. A solution of warm water and mild liquid detergent may be used where necessary and then rinsed thoroughly. Abrasive cleaners or acidic cleaners **MUST NOT BE USED** under any circumstances.

Avoid contact with solvents.

Please retain these instructions for future reference.